



### In This Issue:

- [6GHz Wireless Survey](#)
- [Cisco Advisory](#)
- [Configuring SYSLOG](#)
- [Cisco Secure Client](#)
- [Wireless 3D Analyzer](#)
- [Contact Center Webinar](#)
- [New Certifications](#)
- [Join Our Team](#)

## 6GHz Wireless Survey

If you are upgrading your Wi-Fi, then it is highly recommended that you upgrade to a system that supports 6GHz Wi-Fi 6E standards. With all of the benefits that come with using the 6GHz spectrum, there are also design considerations to keep in mind. DSI Tech works closely with technology partners to achieve your wireless goals and we're ready to perform 6GHz wireless surveys. [Reach out to schedule yours today!](#)

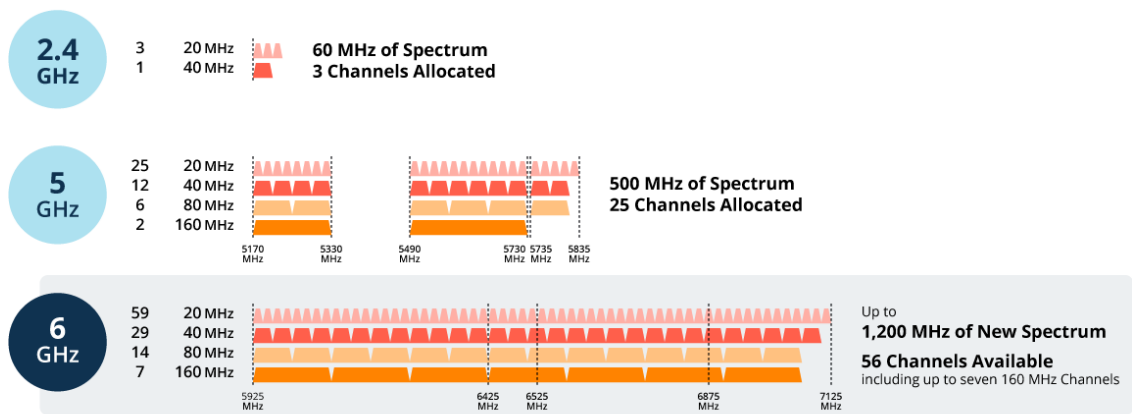

Spectrum available in the 6 GHz band varies by geography.

[Contact Us](#)

# Cisco Advisory

## APs Manufactured Starting September 2022



Cisco C9105/C9120/C9130 Access Points manufactured in September 2022 and later may require code upgrades. The [affected products](#) cannot join Wireless LAN Controllers (WLCs) running software released prior to August 2022.

[Read More](#)

## Configuring SYSLOG TLS



SYSLOG over UDP/512 has been used for ages to collect messages from devices. [SYSLOG TLS](#) is a more modern method that uses Transport Layer Security to facilitate a TCP based secure transport for SYSLOG messages. Check out this [documentation](#) from Cisco to deploy secure SYSLOG transfer in your environment:

[Read More](#)

## Introducing Cisco Secure Client

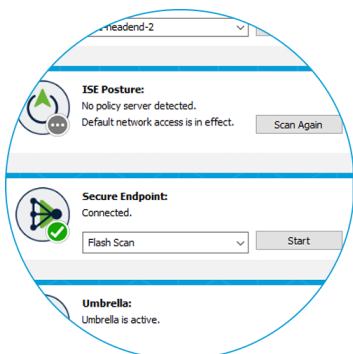

Formerly known as AnyConnect, [Cisco Secure Client](#) offers a shared user interface for tighter and more secure remote access along with management of endpoint security agents. Cisco Secure Client is built upon Cisco AnyConnect, which provides not only Remote Access VPN/ZTNA services but also integrated module security services.

[Read More](#)

## Wireless 3D Analyzer

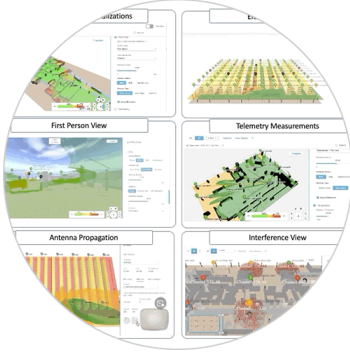

Architecting the best wireless coverage for a specific environment depends on many different physical factors like obstacles (walls, doors, windows), building geometry, furniture, and materials as well as the user density and intended usage. The challenge is that RF, unless visualized somehow, is invisible. The goal of [Cisco Wireless 3D Analyzer](#) is to address challenges like these and enable RF design like never before possible.

[Read More](#)



**COLLABORATION CHAT SERIES:**

# Contact Center

**[ Tuesday, Sept. 13, 1:00-1:30PM ET ]**

**CLICK HERE TO REGISTER**

In this fourth session of the event series, we'll take a look at Cisco Contact Center solutions that use online chat, texting, email, social media, and voice communications.



Identify current challenges, learn about [the platform](#), hear about real customer success stories, and see how you can get started (or improve your current setup!).

This chat includes a Q&A panel session and interactive games with gift card prizes for the winners! Download the Slido app on [Apple](#) or [Google](#) to get ready for some fun! *Note: You can attend one or all sessions of this series; they are standalone topics and content.*

Count me in!



## New Certifications



The DSI Team recently earned [Cisco's Environmental Sustainability Specialization](#)! By offering new solutions and new ways to use and reuse our technology, together we can help you achieve sustainability goals, meet government mandates, and transform your business.

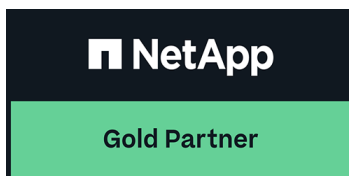

DSI Tech is now a NetApp Gold Partner! [NetApp](#) provides a data storage solution that's easy to implement, easy to use, easy to manage, and sets you up to address today's complex IT challenges and pave your path to the cloud. We can help you choose the right platform and build the right environment, all within budget.

See our full list of certifications

 *Open Positions*

# Join the DSI Tech Team

DSI Tech is committed to employee satisfaction through our benefits program and a friendly, team-based culture. We provide a positive environment for you to grow, learn, and excel as an industry professional. If you are looking for an exciting place to work that challenges your abilities and is financially solid and growing every year, then this is the place for you!

The DSI Tech team is growing! [Current job openings & career paths](#) include **Engineering, HR, Project Management, Purchasing, and Sales (CX, Inside Reps, and Outside Federal & SLED in various locations)**.

[Join our team!](#)

[Visit the Tech Topics Newsletter Archives Webpage](#)



DSI Tech provides complete IT solutions and services that are secure, innovative, energy efficient, and cost effective. Our customers include State & Local Government and Education (SLED), Federal agencies, and commercial companies. We hold nationwide contracts that are supported by a team of industry professionals and certified engineers. Learn more at [dsitech.com](https://dsitech.com).



*Copyright © 2022 DSI Tech, All rights reserved.*

Grow your business with  **mailchimp**